

Office

The Office Group (TOG) – London

A curtain in energetic yellow creates privacy.

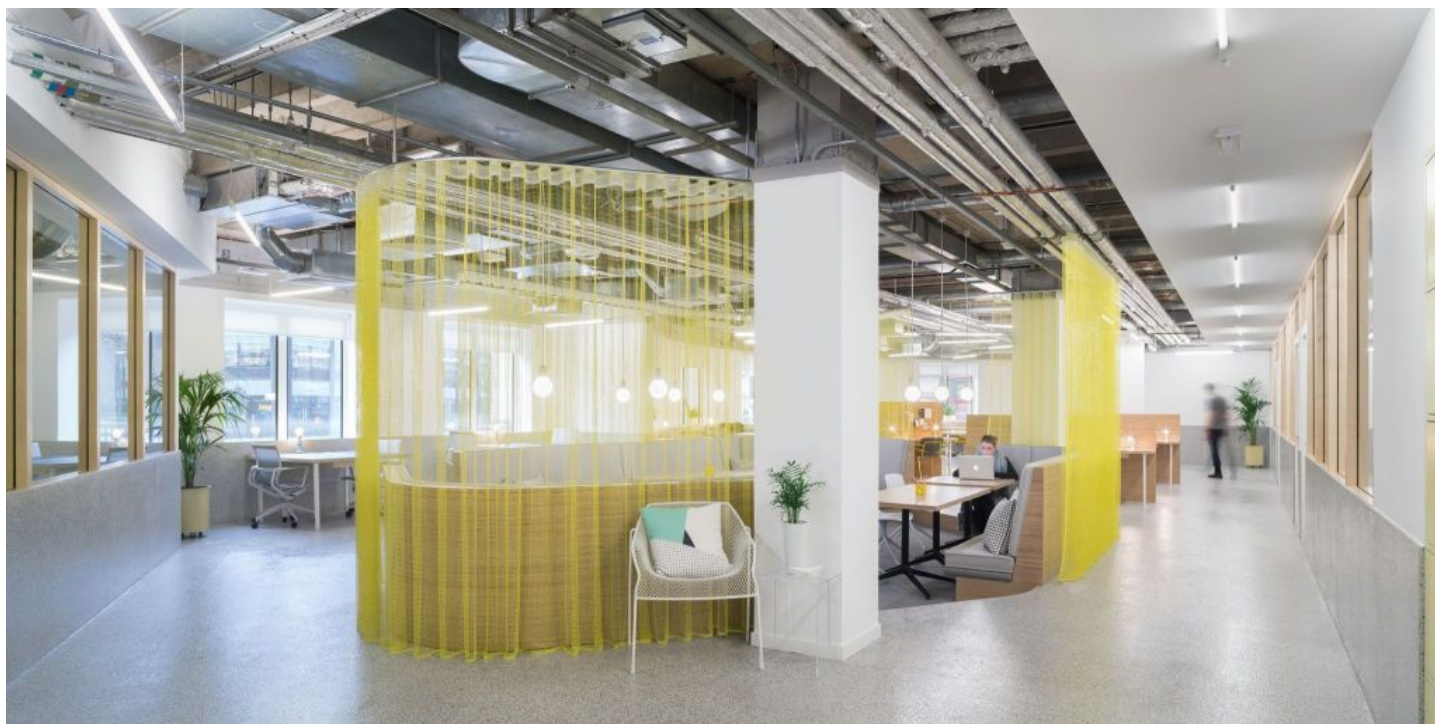

Starting Point

The Office Group provides flexible spaces to meet and work across the UK. Shed wanted to reflect the progressive spirit of the Office Group movement and its new-start-up residents, which led to a desire for a new aesthetic. «Not another mid-century modern interior» was the starting point, as was the challenge of transforming a 1980's office block.

Solution

Dividing the site into component parts allowed each area to have a signature palette of colours and finishes. The Clubroom is a more focused, members-only room, surrounded by sought-after «studio» offices. The open mesh curtain Malta circles a generous sunken banquette, to create an intimate working environment without putting up walls and blocking natural light.

Object

The Office Group (TOG), Angel, London, England

Concept

Shed, London, England

Photos

[James Medcraft](#), England

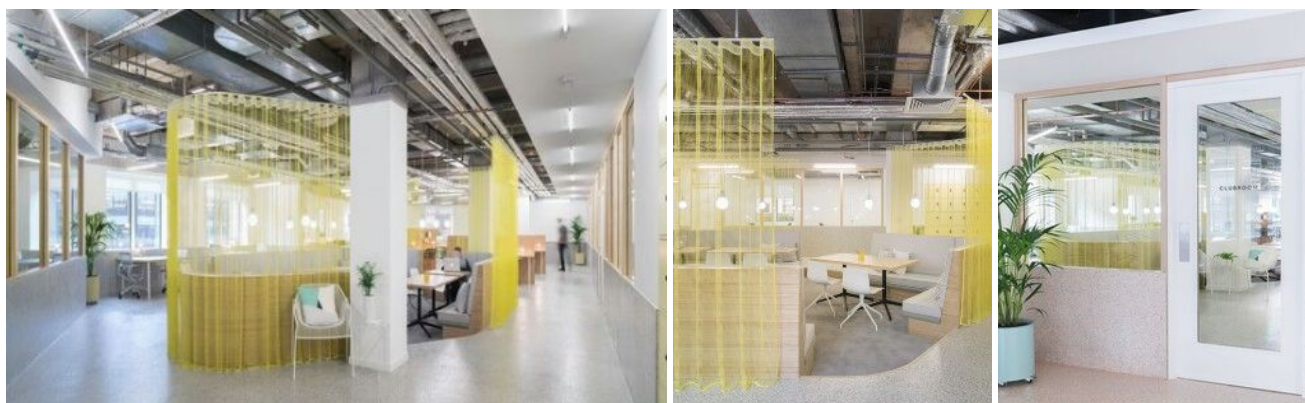

Textiles Used

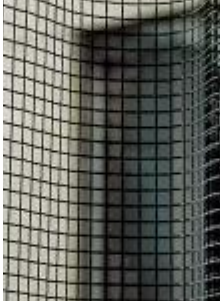

MALTA III

Article-Number: 0100590

Use: Transparent/semi-transparent curtain fabric

Number of colors: 16

Material: 100% Flame retardant (Trevira CS)

Fabric width: 300 cm/118 inch/3.28 yard

Weight: 94 g/m²

Light fastness: 5-6



DELTACOUSTIC

Article-Number: 0101125

Use: Transparent/semi-transparent curtain fabric

Number of colors: 17

Material: 100% Flame retardant (Trevira CS)

Fabric width: 300 cm/118 inch/3.28 yard

Weight: 125 g/m²

Sound absorption: α_w 0.60

Light fastness: 6-7



GAMMACOUSTIC

Article-Number: 0100885

Use: Transparent/semi-transparent curtain fabric

Number of colors: 10

Material: 100% Polyester flame retardant

Fabric width: 300 cm/118 inch/3.28 yard

Weight: 74 g/m²

Sound absorption: α_w 0.50

Light fastness: 7