

Healthcare

Haslibrunnen, Senior Care Center – Langenthal

Textile variety for a cosy ambience.

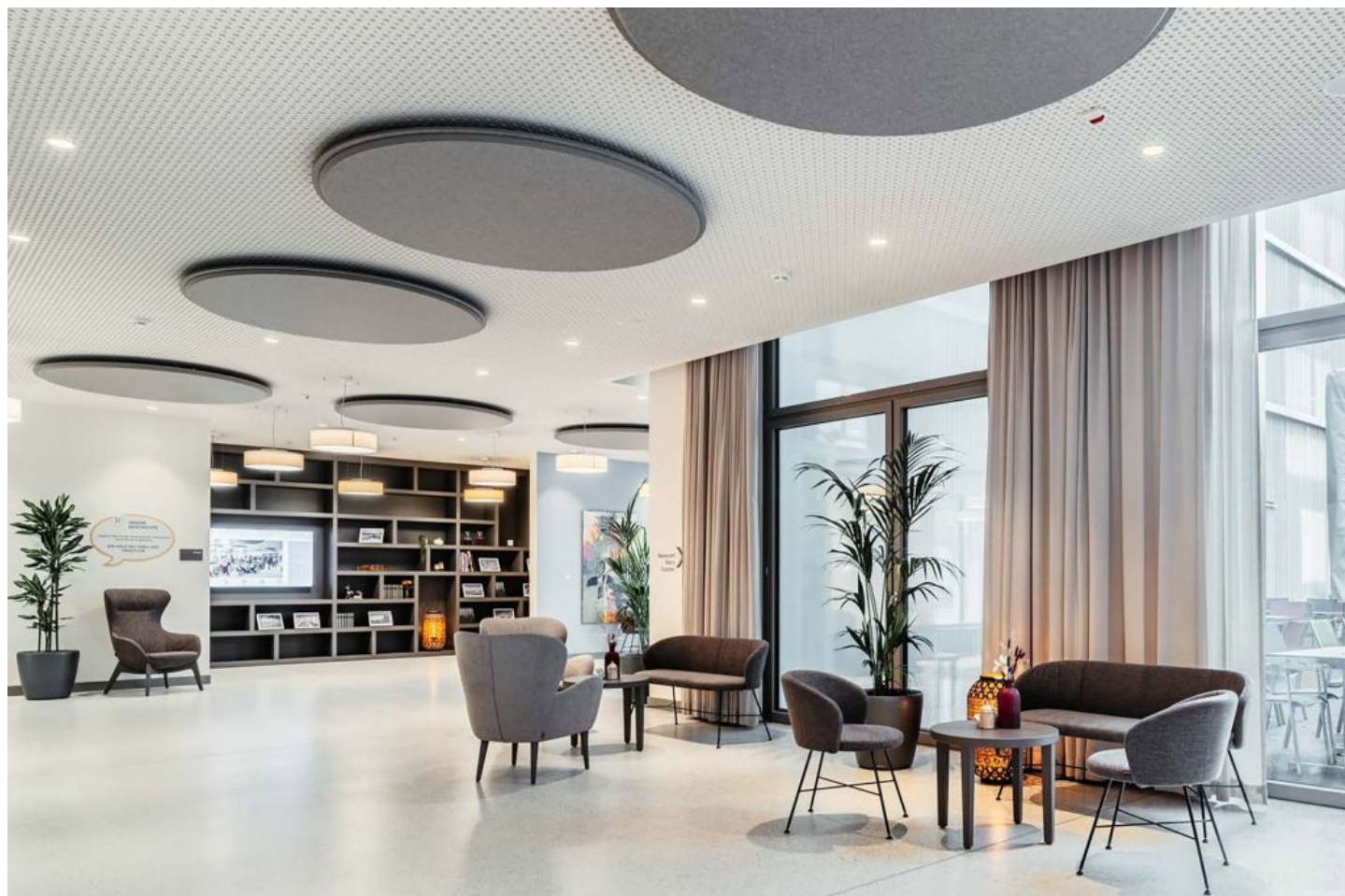

Starting Point

The Senior Care Center – Haslibrunnen in Langenthal blends harmoniously into the existing residential area. The architecture combines different building structures through a building volume consisting of individual structures. This arrangement creates high-quality outdoor courtyards and ensures optimal lighting for the 152 care rooms. The uniform architectural language and staggered window elements break up the strict structure of the residential units and strengthen the integration into the neighbourhood.

Solution

Various curtain fabrics have been selected to promote a pleasant living atmosphere. SONORACOUSTIC improves the room acoustics, SONOR COLOR sets colourful accents, while JASPIS and MIDNIGHT add an elegant, calming touch. When selecting the textiles, attention was paid to colour and materiality in order to clearly distinguish the different zones: Private areas such as the residents' rooms, semi-private areas such as the lounge areas in the residential groups and public areas such as the restaurant. This differentiation is harmoniously coordinated with the floors and wall colours to subtly highlight the respective private spheres for residents and visitors. The textile solution thus contributes to enhancing the quality of life and completing the overall aesthetic appearance.

Object

Haslibrunnen, competence centre for the elderly, Langenthal, Switzerland

Concept

Ducksch Anliker AG; Best Raum in Bern Stefan Leuenberger | Steffen Raumkonzepte AG

Photos

Lumeos lumeos.ch, Roland Kämpfer, Langenthal, Switzerland





Textiles Used



SONOR COLOR III

Article-Number: 0005910

Use: Transparent/semi-transparent curtain fabric

Number of colors: 37

Material: 100% Flame retardant (Trevira CS)

Fabric width: 330 cm/130 inch/3.61 yard

Weight: 170 g/m²

Sound absorption: α_w 0.15

Light fastness: 5-6



JASPIS II

Article-Number: 0036670

Use: Transparent/semi-transparent curtain fabric

Number of colors: 37

Material: 100% Flame retardant (Trevira CS)

Fabric width: 320 cm/126 inch/3.50 yard

Weight: 54 g/m²

Light fastness: 5-6



MIDNIGHT

Article-Number: 0102185

Use: Dim-out fabric/blackout

Number of colors: 22

Material: 100% Polyester flame retardant

Fabric width: 300 cm/118 inch/3.28 yard

Weight: 360 g/m²

Sound absorption: α_w 0.95

Light fastness: 5



SONORACOUSTIC

Article-Number: 0102150

Use: Transparent/semi-transparent curtain fabric

Number of colors: 12

Material: 100% Flame retardant (Trevira CS)

Fabric width: 300 cm/118 inch/3.28 yard

Weight: 169 g/m²

Sound absorption: α_w 0.35