

Office

# BMW Group Campus – Salzburg

Textile solutions for a modern working environment.

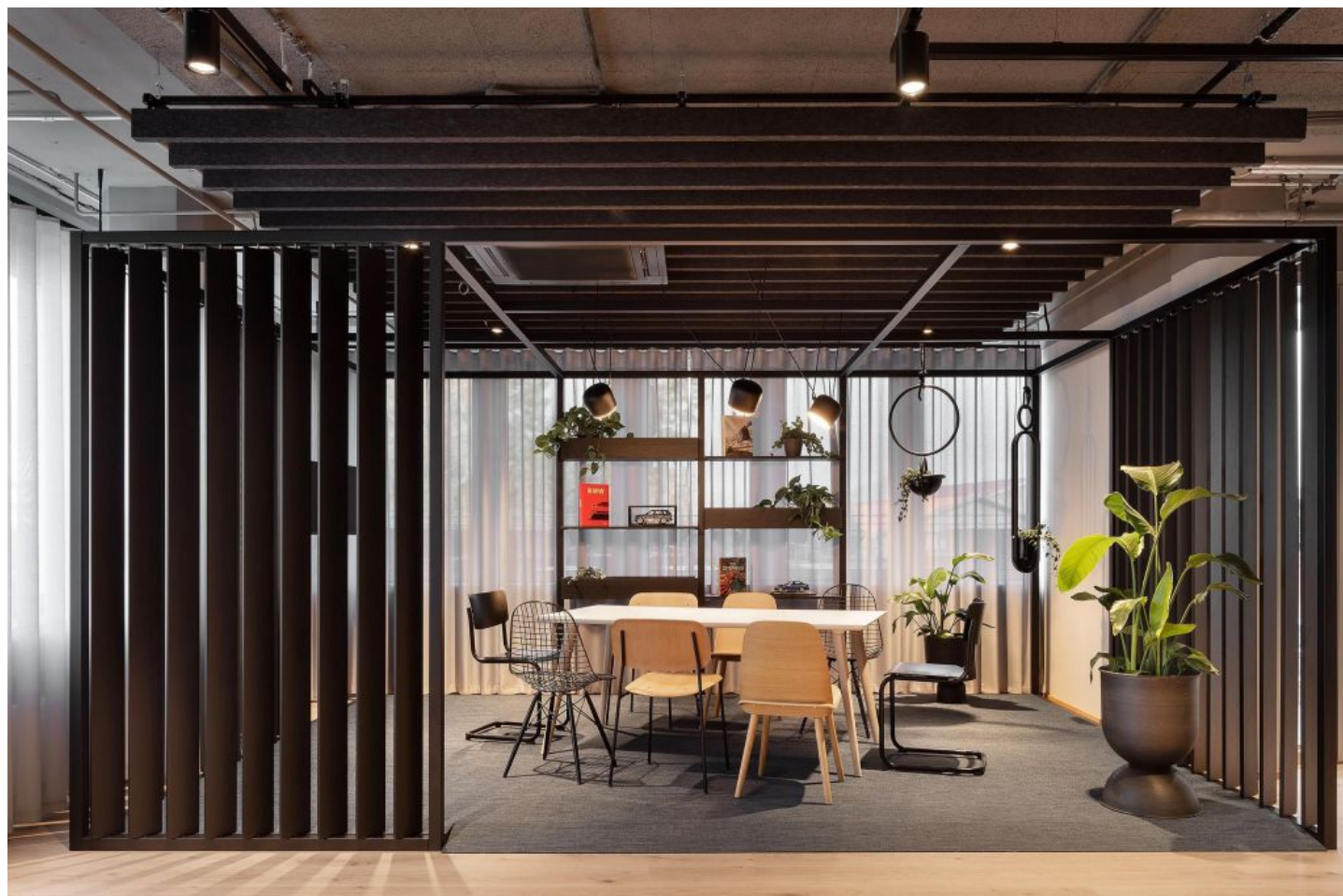

## Starting Point

New workplaces and collaboration areas were created at the BMW Group Campus in Salzburg. In addition to spatial adjustments and staff increases, the offices and common areas were to be made more attractive – in line with the new BMW Group corporate identity. The aim was to create a better working atmosphere and a higher quality of stay.

Structural and design measures were implemented in both the North Campus and the South Campus. The previously functional, grey rooms were to be transformed into modern feel-good spaces with a new room concept featuring acoustically effective and pleasant-to-touch materials.

## Solution

The use of high-quality textiles has created a balance between functionality and aesthetics. The transparent, aluminium-metallised SHELTER fabric provides glare and heat protection for the windows, ensuring pleasant lighting conditions and an optimum indoor climate. At the same time, its filigree, screen-like appearance blends seamlessly into the modern design concept.

The SONOR curtain fabric was integrated to create a cosy atmosphere. Its natural, linen-like structure not only conveys visual warmth, but also offers acoustic benefits.

This has transformed the previously plain rooms into inspiring working environments that meet the requirements of modern workplaces and create an inviting atmosphere – in keeping with the BMW Group's philosophy.

## Object

BMW Group Campus, Salzburg, Austria

## Concept

Blue Scope Berlin GmbH, Aniko Horvath |  
Andreas Pauli Riemer

## Photo

Ken Schluchtmann [diephotodesigner.de](http://diephotodesigner.de)

[Textiles for glare and heat protection](#)



# Textiles Used

---



## SHELTER

**Article-Number:** 0101155

**Use:** Transparent/semi-transparent curtain fabric

**Number of colors:** 17

**Material:** 100% Polyester flame retardant

**Fabric width:** 300 cm/118 inch/3.28 yard

**Weight:** 246 g/m<sup>2</sup>

**Sound absorption:**  $\alpha_w$  0.25

**Light fastness:** see downloads

---



## SONOR COLOR III

**Article-Number:** 0005910

**Use:** Transparent/semi-transparent curtain fabric

**Number of colors:** 37

**Material:** 100% Flame retardant (Trevira CS)

**Fabric width:** 330 cm/130 inch/3.61 yard

**Weight:** 170 g/m<sup>2</sup>

**Sound absorption:**  $\alpha_w$  0.15

**Light fastness:** 5-6